

# How to Set Up a Therapeutic Paracentesis

## What to get:

- Abdominal paracentesis kit—this comes with two tubes: extension set and secondary set
- Yueh (Cook) catheter
- Large vacuum jug
- Blue connector tube—this will go from wall suction to jug

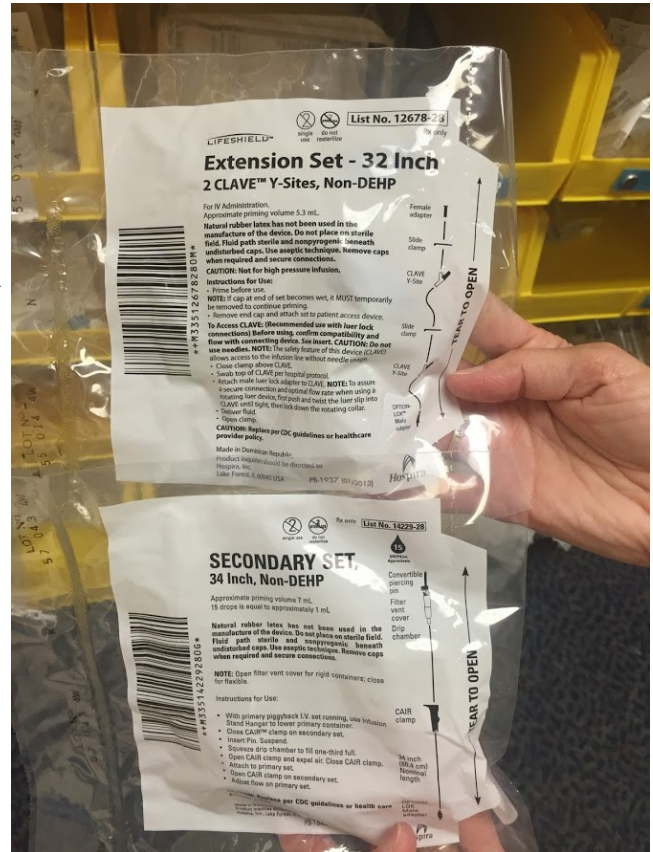
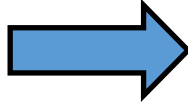

- Green (or just another blue) connector tube—this you will cut and place from the jug to the para kit's small tubing

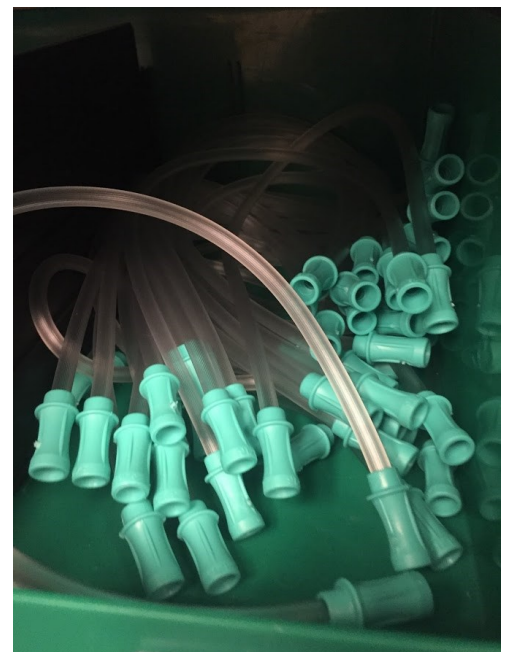

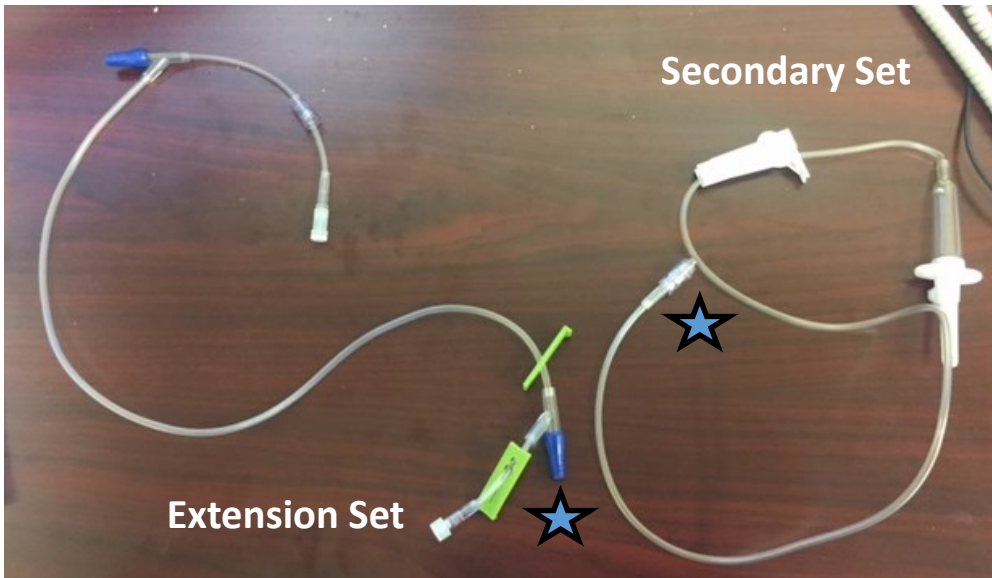

**1. Attach the starred ends of the extension and secondary set:**

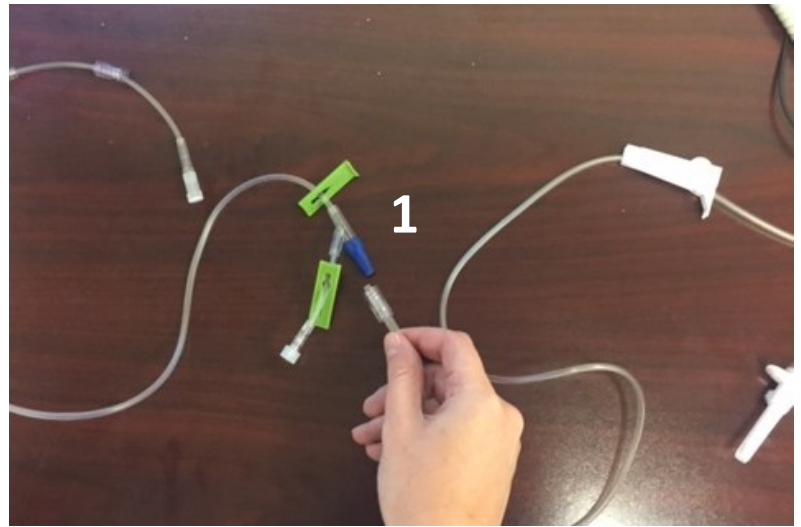

**Should look like this:**

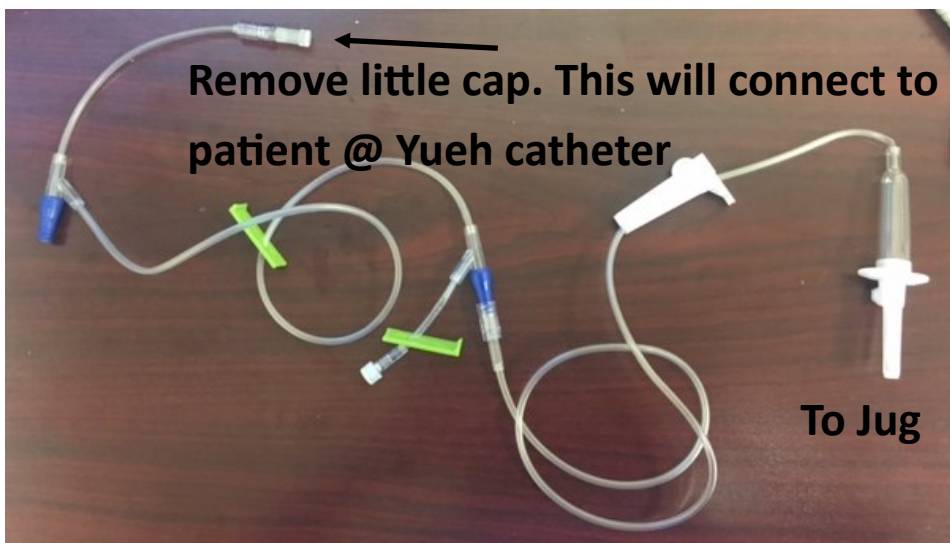



**2. Cut off end of blue or green connector tube (~ 2 inches). Connect this to pointy end of secondary set:**

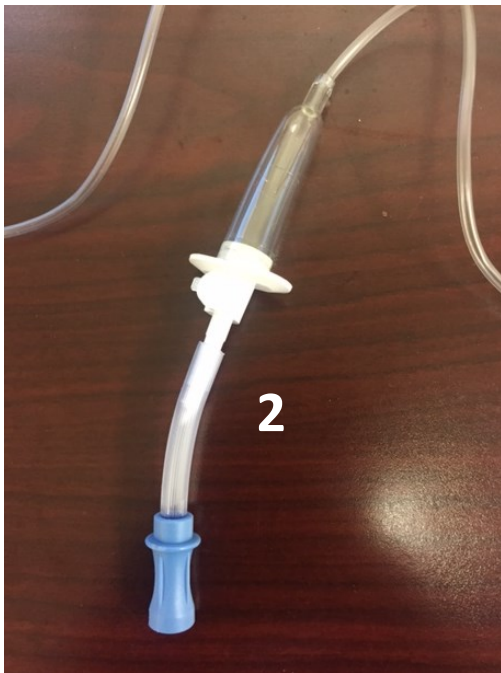

**3. Attach to jug at spot marked "patient"**

**4. Take 2nd connector tube, attach one end to wall suction, the other end to jug at spot marked "vacuum"**

**5. Set suction to REG, turn dial so needle is in the yellow-orange range**

